

# Wind speed type ultrasonic sensor

product model

NU200E12TR-1 T

Product appearance



product size

unit:mm

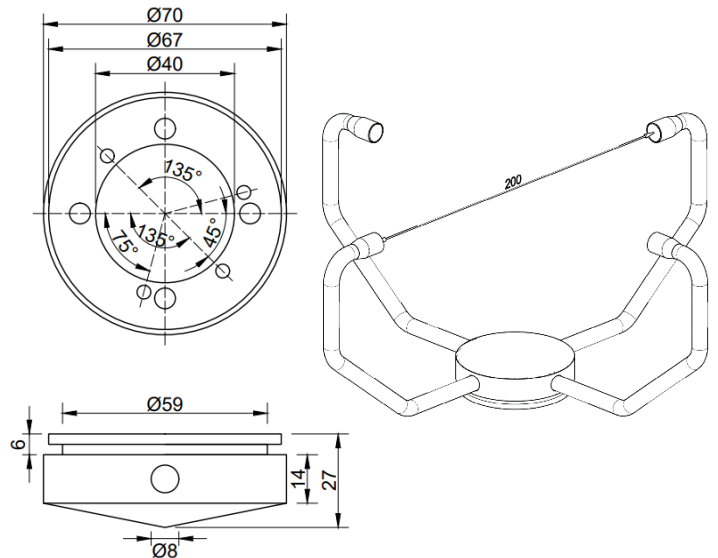

product features

- The eggplant structure is simple
- The lid blind area is small
- waterproof and dustproof

technical parameter

- Product classification: wind speed type
- Product category: sending and receiving is integrated
- Center frequency: 200.0KHz± 4%
- Comprehensive sensitivity: see the figure on the right
- Resolution: 1m m
- Yu Zhen: 600 us Max
- Beam angle (-6dB): 10 ± 2°
- Static capacitor: 150 Pf ± 20%
- Maximum input voltage (pulse wave): 500 Vp-p
- Typical test range: 2m
- Operating temperature: -20~80°C
- Storage temperature: -40~85°C
- Shell material: stainless steel
- Weight: 662 g

- All of the above parameters were tested at 25°C for reference only.
- Please contact us for any special needs.

Typical application

- High-precision distance detection
- Diaphene double control
- Robot design as well as the research
- Disseal level detection

Impedance / phase

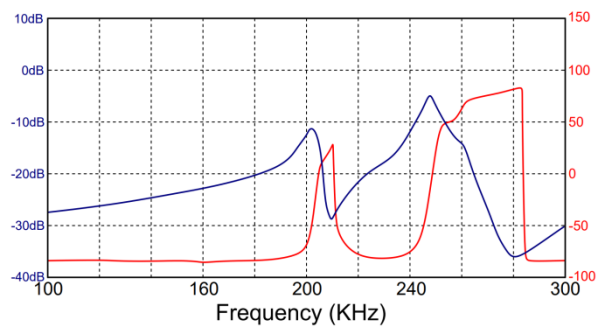

overall sensitivity

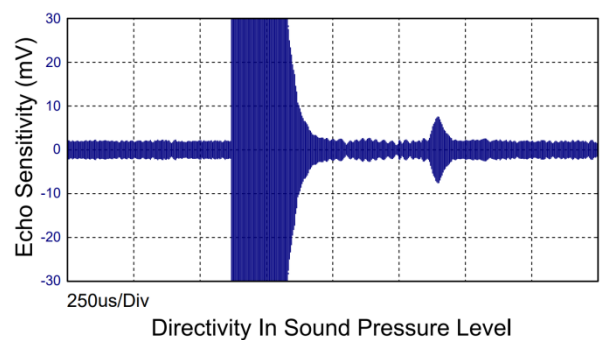

beam angle

